

## QuickSwitch® Model 6249 Quad Channel LC Duplex A/B Keylock Switch, Single Mode, with Telnet and GUI Remote

### INTRODUCTION

The QuickSwitch® 6249 4-Channel LC Duplex A/B Switch allows the user the capability of sharing a single port interface device, connected to the "COMMON" port, among two other devices, connected to the "A" and "B" ports for each of four channels. The QuickSwitch® 6249 is enclosed in a 2U, full rack size, all metal black chassis designed to fit in a standard 19" rack.

The switch may be controlled manually via front panel keylock or Remote Ethernet Telnet & GUI. Switch position status may be attained via the front panel LED display.

**Remote Control:** access can be accomplished using an Ethernet 10/100 BASE-T connection and either Telnet commands or graphical user interface (GUI). The unit can also be controlled via dry contact closure signaling to the rear panel DB9 REMOTE port.

### FEATURES:

- Each of four channels allows quick connection to any one of two LC interface devices from one COMMON device.
- The switch ports are transparent to all data.
- All fiber signals are switched via break-before-make MEMS-based mirror/prism switch technology.
- The unit maintains last set position on power loss and continues to pass data.
- Front panel keylock control.
- Independent control of channels via channel Keylock Switch.
- Simultaneously switch all channels via Group Keylock Switch.
- Remote Control via Telnet command interface and Graphical User Interface.**
- Front panel LED's display present position and power status.
- All A, B, and COM ports are LC duplex, Single Mode (SMF-28), 9/125 micron, and support a dual window wavelength of 1300nm and 1550nm.
- The fiber ports are configured per TIA/EIA-568-B.3, where the TX of the COM port is routed to the RX of the A/B ports and vice versa.



### SPECIFICATIONS:

**PORT CONNECTORS:** (3) LC duplex female connectors labeled A, B, and COMMON for each of four channels.

### FRONT PANEL CONTROL:

- CHANNEL KEYLOCK SWITCH (CH1 – CH4)** – Four front panel channel keylock switches allow the switch position to be changed independently for each channel.
- GROUP KEYLOCK SWITCH (A/B)** – A single Keylock Switch allows the channel positions to be changed simultaneously.

**DISPLAY:** (8) Front panel LED's display switch position and power status.

**REMOTE CONTROL:** (1) RJ45 (F) connector on rear panel accepts 10/100Base-T LAN Ethernet that uses both TELNET commands and a GUI Interface for Remote Control operation.

**POWER:** UL approved 100VAC-240VAC, 50Hz-60Hz wall mount power module supplies 12 VDC, 500mA to the unit. Has 2-prong, US, non-polarized plug.

**DIMENSIONS:** 19.0" W x 3.5" H x 9.1" D.  
(48.3 x 8.9 x 23.3 cm)

**WEIGHT:** Approximately 5.6 lbs. (2.6 kg)

**WIDE RANGE POWER OPTION AVAILABLE:** (Cat No 517277) **CE, RoHS, and UL** listed table mount power module, 100VAC-240VAC, 50Hz-60Hz in place of standard power module that is included with the unit. Has IEC 60320 C14 inlet.  
**Ideal for international applications.**

### QuickSwitch® 6249 Quad Channel LC Duplex A/B Switch Application

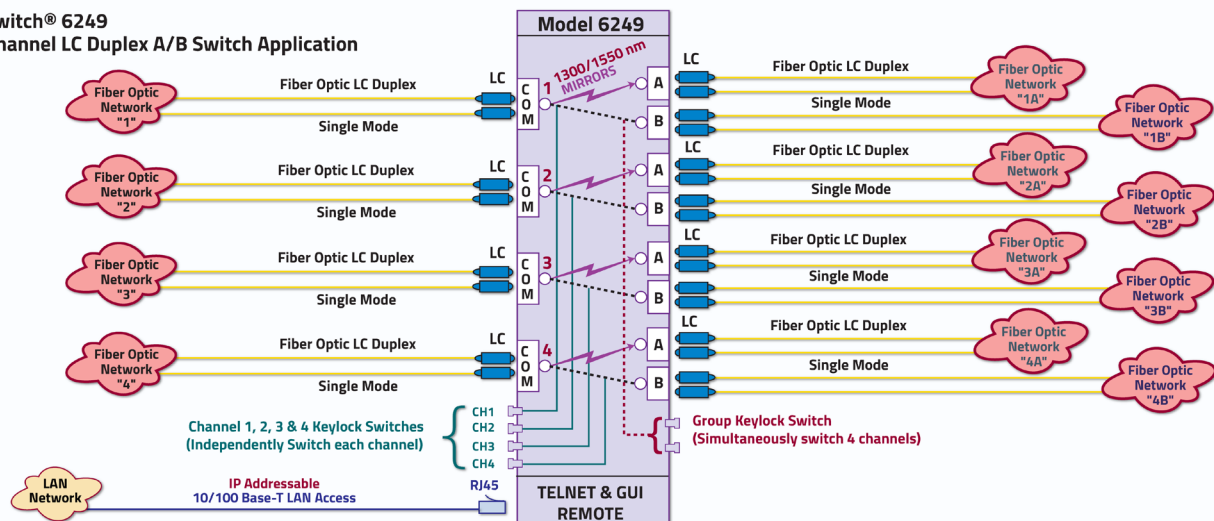

## UTILIZING THE USER-FRIENDLY REMOTE GRAPHICAL USER INTERFACE (GUI) SOFTWARE

### CHANGING POSITION AND LOCK STATUS

To change the switch position, click on the radio button "A" or "B" as desired. Locking and unlocking the front panel pushbutton can be done by clicking on the "Locked" or "Unlocked" radio buttons. See Figure 1.

### QUERYING THE STATUS OF THE UNIT

Once connected, the GUI will stay up-to-date on the current position and status of the unit. Any changes that are made outside of the GUI, such as by pushbutton, will be reflected in the GUI. These changes will cause the radio buttons of the GUI to automatically change to show the new status. The GUI will report the source of the most recent change in the bottom left of the panel. See Figure 1.

### GUI SOFTWARE FEATURES

- Access User Interface via standard web browser.
- **Easy to use, simple point and click operation.**
- Remotely access to control or monitor the Model 6249 Switch System.
- Users can change the switch's IP address.
- LAN access gives users across the LAN or over the internet access to control if user network is configured accordingly.

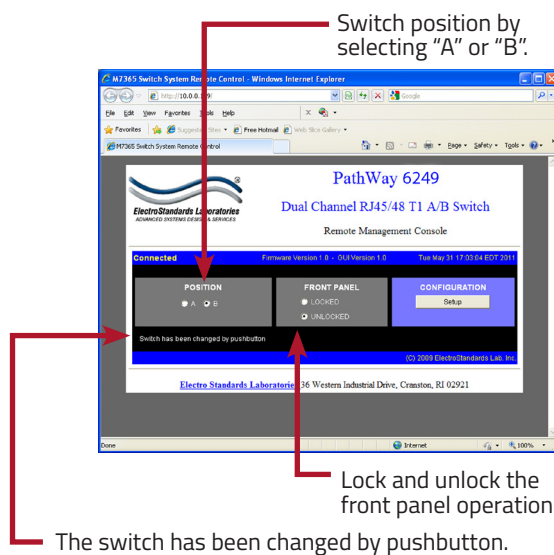

Figure 1: Change the position and lockout from the GUI. The GUI is alerted to changes in the unit status.